

Atlantic Pools & Spas, Inc.
P.O. Box 417
Ocean City, Maryland 21843
(410) 641-4500

Equipment Submittals

Woodfield Preserve
Broadkill Road
Route 16
Milton, Delaware 19968

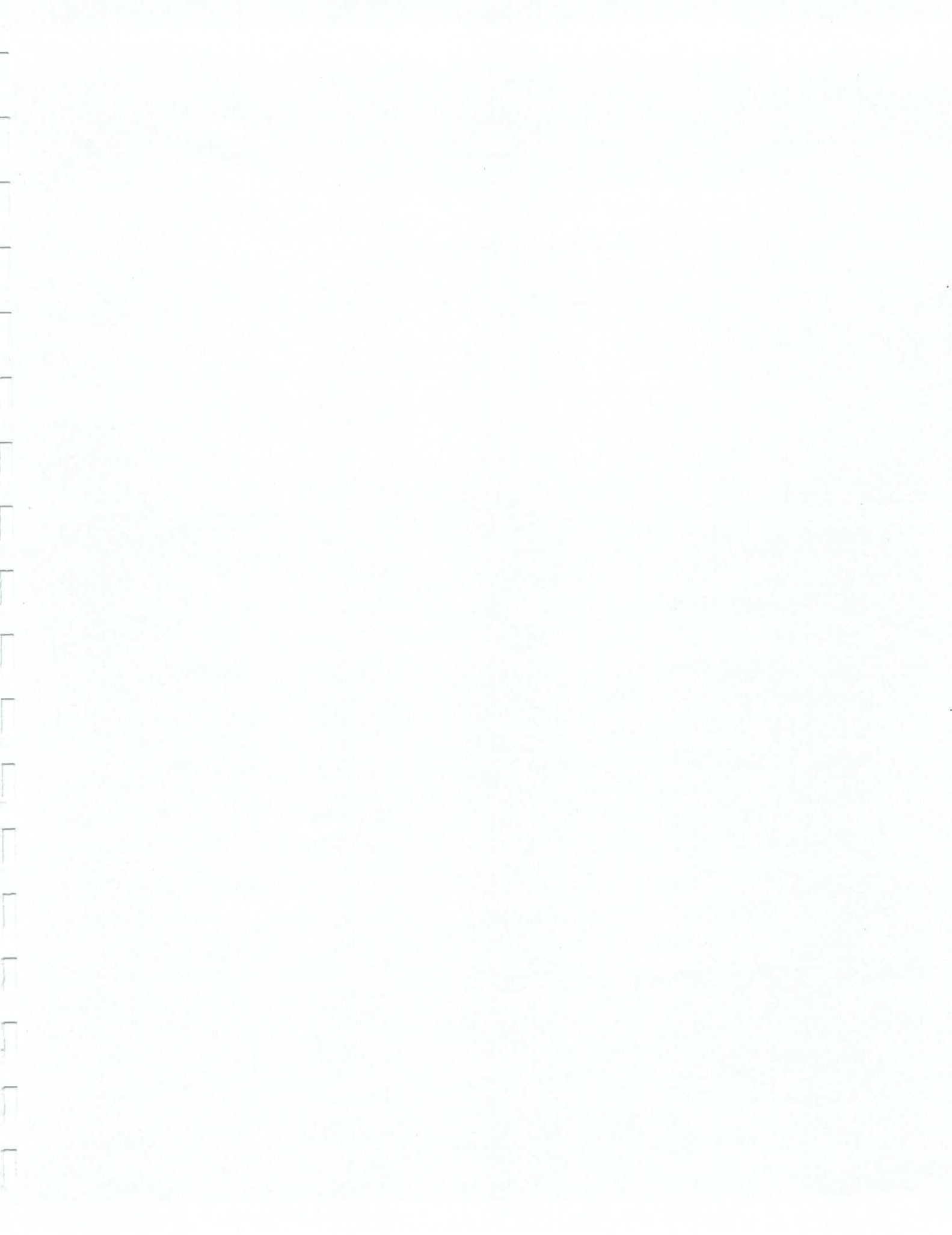

Atlantic Pools & Spas, Inc.

P.O. Box 417

Ocean City, MD 21843

(410) 641-4500

Electrician's Requirements: Woodfield Preserve

APS

Electrical Contractor

<u> X </u>	Lights in pool connected to Junction Box Two 500 Watt Equivalent Lights	<u> </u>
<u> </u>	Junction Box into Filter Room	<u> X </u>
<u> </u>	Deck Lights, if applicable	<u> X </u>
<u> </u>	Ventilation Fan in Filter Room	<u> X </u>
<u> </u>	Lights in Filter Room	<u> X </u>
<u> </u>	Electrical Requirements into electric panel in Filter Room: 100 Amp, 3 Phase	<u> X </u>
	Wiring to Include:	
<u> </u>	Wiring of Pumps:	<u> X </u>

Receptacles

 X

 X

Pool Bonding

Deck Bonding

 X

HI-FLOW™

system control valves

Built to last

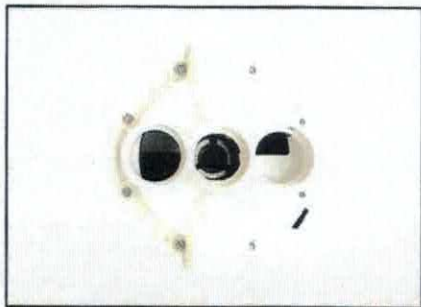

- Solid, injection molded PVC housing permits leak-free solvent welds to PVC piping.
- Full six-position, positive-lock operation plus special winterize position provides access to full range of filtration system capabilities.



- Large, reinforced, one-piece handle for years of trouble-free operation.
- Hi-Flow™ valves feature a high efficiency, center-intake diverter made of heavy-duty, glass-filled Noryl®.

- Full two-inch inlet and outlet ports for unrestricted water flow during all cycles.
- Engineered to accommodate up to 125 gpm flow rates with proper system plumbing and compatible pump/filter combinations.
- Clearly and permanently marked ports for ease of plumbing either sand or d.e. filters.



valve position	water flow through system	
	sand filters	d.e. filters
filter	through filter (top to bottom) return to pool	through filter (bottom to top) return to pool
backwash	through filter (bottom to top) out to waste	through filter (top to bottom) out to waste
rinse	through filter (top to bottom) out to waste	through filter (bottom to top) out to waste
waste	bypasses filter, direct from pump to waste	bypasses filter, direct from pump to waste
recirculate	bypasses filter, direct from pump back to pool	bypasses filter, direct from pump back to pool
closed	no flow past pump inlet port on valve	no flow past pump inlet port on valve
winterize	diverter separated from seal for off-season storage	diverter separated from seal for off-season storage

- All the proven Hi-Flow performance features are built into our top-mount, multi-port sand filter valves.

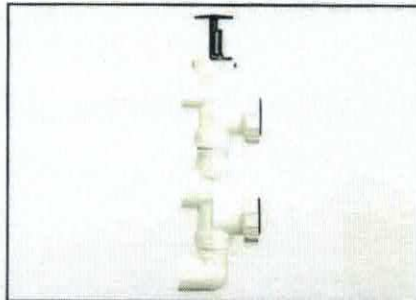

- Hi-Flow™ quality is also available in an economical, simple-to-operate slide valve.

Noryl® is a registered trademark of General Electric Corporation.



PAC•FAB, INC.

Home Office
Sanford, NC
(919) 774-4151

Pac-Fab West
El Monte, CA
(818) 442-7795

Do It Right The First Time.™



PAC•FAB
Pumps • Filters • Accessories™



EQ SERIES® HIGH PERFORMANCE COMMERCIAL PUMP

FOR COMMERCIAL AND HIGH-END RESIDENTIAL SWIMMING POOLS AND OTHER WATER APPLICATIONS



EQ Series pumps are designed for maximum efficiency and quiet operation in every detail. They are the only non-corrosive, all plastic pumps designed for the commercial pool and water applications market.

The EQ Series pump impellers are manufactured for true breakthrough performance, allowing for lower loads and longer motor life. Available with and without the strainer pot. Available in flows to 800 GPM, and from 3 to 15 HP.

STANDARD FEATURES

- Close coupled for quiet, stable flow operation.
- Lightweight for easy, one-man installation.
- Clear Cam and Ramp™ Lid for added service convenience.
- 6" suction and 4" discharge with strainer pot.
- Closed impeller for long life and durability.
- Available in single- and three-phase models.
- Great for use with Acu Drive™ XS Variable Frequency Drives.
- Self-priming under NSF standards; NSF listed.

EQ SERIES® HIGH PERFORMANCE COMMERCIAL PUMP

EQ Series Commercial Pump Performance Curve

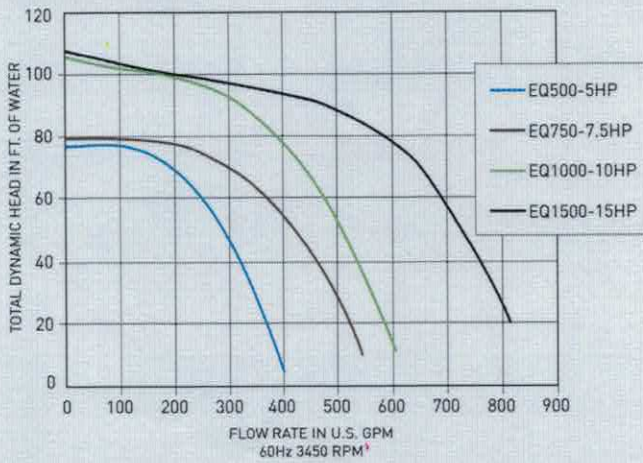

EQ Series WaterFall™ Pump Performance Curve

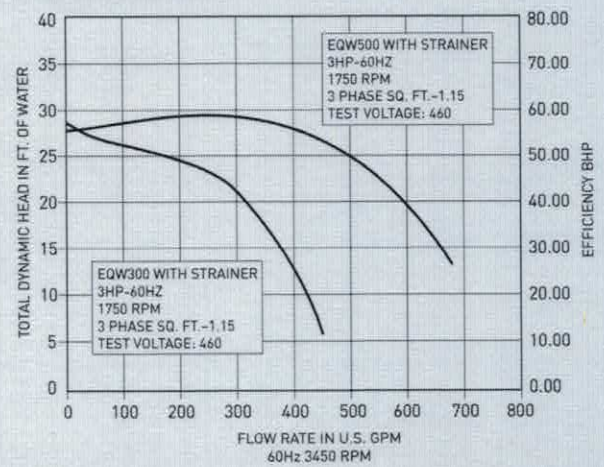

MATERIALS AND DESIGN

Pump Body

Volute type, back pull-out design.

- **Port Size**
6" – ANSI Rated 150 bolted flange suction port¹.
4" – ANSI Rated 150 bolted flange discharge port¹.
- **Material - Volute & Motor Adapter**
PPO Resin
- **Impeller**
PPO Resin
- **Base**
6061 aluminum design, slotted for mounting ease.
- **Corrosion Prevention**
All-plastic pump for maximum hydraulic performance and corrosion prevention.

Hair and Lint Strainer

- **Material**
Separate bolt-on PPO Resin body with plastic basket, Polycarbonate Resin Thermoplastic lid, and stainless steel bolts.
- **Size**
6" ANSI Rated 150 bolted flange suction and discharge ports.

Pump Maximum Limits

Liquid Temperature: 104° F

Ambient Air Temperature: 104° F

Motor

Standard JM type. Premium Efficient Class F insulated.

- **Frame Size**
NEMA Rated "C" flange. 230/460V are open drip-proof design.
- **Shaft**
303 stainless steel construction.
- **Design**
3 to 15 HP, 3500 RPM, JM open drip-proof, continuous duty, three-phase and single-phase (5 and 7½ HP only).
- **Bearings**
Double-shielded, single row, deep-groove type, permanently lubricated.
- **Thermal Overload Protection**
All models require external thermal overload protector.

Electrical

- **Power Supply Required**
Three-phase pumps are 208 – 230/460. 3, 5, 7½ and 10 HP single-phase models are available in 230V, 60 Hz. only.

¹ Use ANSI Rated class 150 plastic flange and ½" thick class 150 full flange gasket to make connection.

**EQ Series Commercial Pump
with Strainer Pot 6" x 4"**

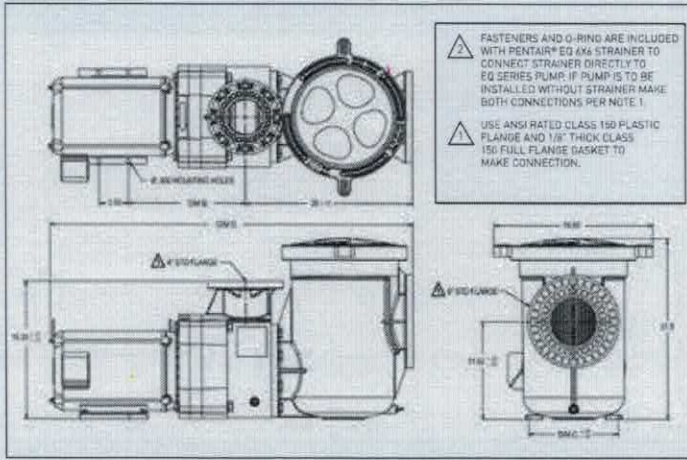

**EQ Series Commercial Pump
without Strainer Pot**

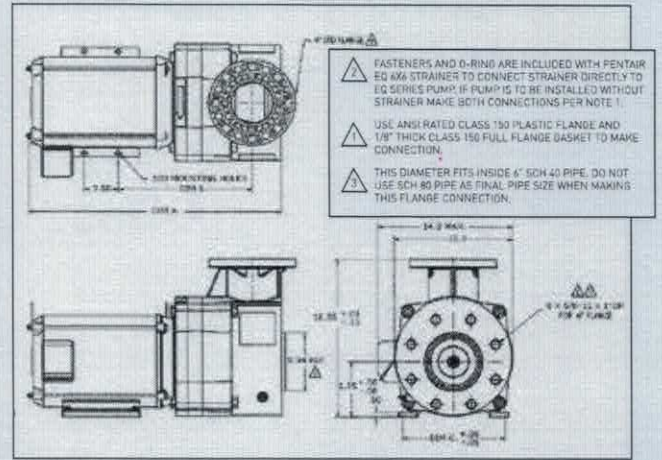

EQ Series Commercial Pump With Strainer Pot 6" x 4"

Part #	Description	Voltage	Amps	Phase	HP	Wt	Dim. A	Dim. B	Dim. C	Dim. D
340026	EQW 300 WaterFall	115/230	38/19	1	3	97	26.62	10.03	7.5	43.590
340027	EQWK 300 WaterFall	208 - 230/460	8.4 - 7.9/3.9	3	3	77	23.12	10.16	7.5	40.094
340028	EQW 500 WaterFall	230	23.4	1	5	126	26.62	13.18	9.7	43.590
340029	EQWK 500 WaterFall	208 - 230/460	13.6 - 12.7/6.4	3	5	106	23.12	13.31	9.7	40.094
340030	EQ500	230	19.6	1	5	97	26.62	10.03	7.5	43.590
340031	EQK500	208 - 230/460	13.5 - 12.3/6.2	3	5	77	23.12	10.16	7.5	40.094
340032	EQ750	230	30.4	1	7.5	132	27.53	10.78	8.5	44.590
340033	EQK750	208 - 230/460	20.1 - 18.3/9.1	3	7.5	87	24.50	10.16	7.5	41.560
340238	EQ1000	230	40.0	1	10	179	29.0	11.50	8.5	46.29
340034	EQK1000	208 - 230/460	27.1 - 24.3/12.2	3	10	117	26.31	10.78	8.5	43.290
340035	EQK1500	208 - 230/460	40.0 - 36.0/17.8	3	15	132	26.31	10.78	8.5	43.290

340013	Strainer Pot Assembly including Strainer, Lid, Basket and Hardware
--------	--

EQ Series LC Pump Without Strainer Pot 6" x 4"

Part #	Description	Voltage	Amps	Phase	HP	Wt
340014	EQW 300 WaterFall	115/230	38/19	1	3	97
340016	EQWK 300 WaterFall	208 - 230/460	8.4 - 7.9/3.9	3	3	77
340017	EQW 500 WaterFall	230	23.4	1	5	97
340018	EQWK 500 WaterFall	208 - 230/460	13.6 - 12.7/6.4	3	5	77
340019	EQ500	230	19.6	1	5	97
340020	EQK500	208 - 230/460	13.5 - 12.3/6.2	3	5	77
340021	EQ750	230	30.4	1	7.5	132
340022	EQK750	208 - 230/460	20.1 - 18.3/9.1	3	7.5	87
340237	EQ1000	230	40.0	1	10	146
340023	EQK1000	208 - 230/460	27.1 - 24.3/12.2	3	10	117
340024	EQK1500	208 - 230/460	40.0 - 36.0/17.8	3	15	132

EQ Series pumps are available in 575V and 50 Hz models. Please contact your local sales representative or Pentair office for details.

EQ SERIES® HIGH PERFORMANCE COMMERCIAL PUMP



ENGINEERING SPECIFICATIONS

EQ Series pump

- Recirculation pump shall be Pentair® EQ Series pump Model No. _____ self-priming centrifugal pump, _____ phase, 60 Hz.

General Notes

- Install pump in a cool, dry, well-vented location away from pool heaters and chemical storage.
- Pump should be firmly mounted with pipe supported to prevent vibration and undue operational noise.
- Allow 12" minimum clearance behind motor for servicing.
- Motor overheating may be caused by a voltage drop or excessive voltage. Be sure that wire size and voltage input is properly regulated.

Specifications

- The recirculation pump shall be a self-priming, centrifugal design with a hair and lint strainer as shown in the plans.
- The pump body, seal plate, and attached hair and lint strainer shall be constructed of non-corrosive PPO Resin materials, and close-coupled to an electric motor by means of an adaptor of the same material. The pump body shall have a single suction port with a 6" ANSI Rated 125 bolt flange to the hair and lint strainer. A centerline discharge port of 4" ANSI Rated 125 bolt flange and a winterizing drain port of 1/4" NPT shall be a part of the design.
- The pump shall be a back pull-out design to allow servicing without disturbing piping. The pump shall have a PPO Resin diffuser to aid in priming and it shall contain a replaceable bronze wear ring for the impeller. The impeller shall be of the closed type and PPO Resin, non-overloading at any point on the performance curve. The mechanical shaft seal shall be constructed of ceramic and carbon seal faces, with stainless steel, brass and Buna N materials in the spring bellows portion. The impeller shall be secured to the motor shaft by means of a stainless steel key and locking screw into the end of the motor shaft. The pump shall be capable of operating at up to 50 psi, 104° F continuous water temperature.

- The electric motor coupled to the pump shall be of the NEMA Rated series JM construction with stainless steel shaft inside a removable shaft sleeve of 300 series stainless steel. The motor shall be of an open, drip-proof design (unless otherwise specified) with double-shielded, single row, deep-groove ball bearings. Motors shall be continuous duty rated at 40° C (or better) ambient and be suitable for outdoor installation.
- The pump motor shall be a _____ HP, _____ phase, 60 Hz, 3450 RPM for service on a _____ volt electric supply. The pump shall be rated for _____ GPM at _____ TDH. The pump shall be tested and certified by a nationally recognized testing laboratory to conform to National Sanitation Foundation Standard 50.

Hair and Lint Strainer

- The pump strainer shall consist of a PPO Resin body, Polycarbonate Resin Thermoplastic cover with O-ring seal, and Cam and Ramp™ Lid, and a strainer basket of mineral reinforced polypropylene material.
- The strainer body shall be 6" ANSI Rated 150 bolt flanged suction and discharge ports. The strainer body shall have a removable drain plug for winterizing.
- The strainer basket shall be securely positioned below the suction inlet of the trap, with access for inspection and cleaning through a removable trap body lid. The trap body lid shall be secured by means of a locking ring. The strainer basket shall have a perforation which in total open area is 98 square inches.



1620 HAWKINS AVE, SANFORD, NC 27330 800.831.7133 WWW.PENTAIRCOMMERCIAL.COM

All Pentair trademarks and logos are owned by Pentair, Inc. EQ Series®, Cam and Ramp™, Acu Drive™ and Waterfall™ are registered trademarks and/or trademarks of Pentair Water Pool and Spa, Inc. and/or its affiliated companies in the United States and/or other countries. Because we are continuously improving our products and services, Pentair reserves the right to change specifications without prior notice. Pentair is an equal opportunity employer.

SPECIFICATION SHEET: 45 PUMP SERIES

STENNER PUMPS

SINGLE HEAD ADJUSTABLE OUTPUT



MODELS

- 45MHP2 • 45M1
- 45MHP10 • 45M2
- 45MHP22 • 45M3
- 45M4
- 45M5

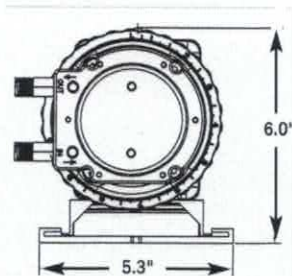
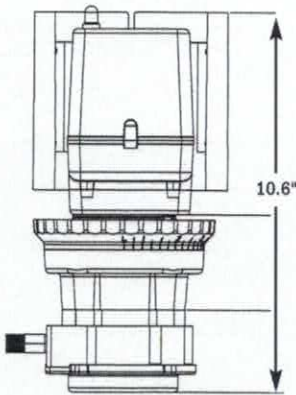

SHIPPING WEIGHT 9 lbs (4 kg)

SINGLE HEAD FIXED OUTPUT



MODELS

- 45MPHP2 • 45MP1
- 45MPHP10 • 45MP2
- 45MPHP22 • 45MP3
- 45MP4
- 45MP5

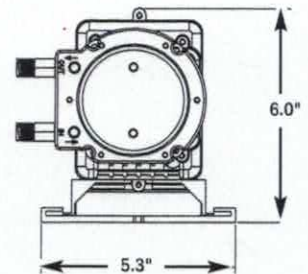
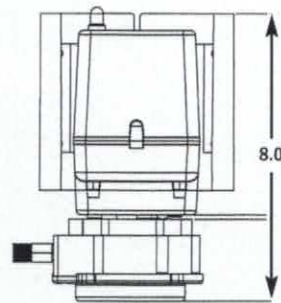

SHIPPING WEIGHT 8 lbs (3.6 kg)



PRODUCT LISTINGS VARY BY MODEL. CONTACT FACTORY FOR DETAILS.

FEATURES

- Positive displacement pump
- 3-point roller design assists in anti-siphon protection.
- Pump head requires no valves, allows for easy maintenance.
- Self-priming against maximum working pressure, foot valve not required.
- Pump does not lose prime or vapor lock.
- Pumps off-gassing solutions and can run dry.
- Output volume is not affected by back pressure.
- Injection check valve included with 45MHP & 45MPHP models.
- Easy to change pump tube; lubrication is not required.
- Pump tubes and pump heads interchange between models.
- Models tested by WQA to conform to ANSI/NSF STD 61.
- Adjustable models tested by ETL to conform to ANSI/NSF STD 50.
- All pump accessories included allow a fast and easy installation.



Stenner Pump Company
3174 DeSalvo Road
Jacksonville, Florida 32246

Phone 904.641.1666
US Toll Free 800.683.2378
Fax 904.642.1012

www.stenner.com
sales@stenner.com
© Stenner Pump Company All Rights Reserved

SPECIFICATION SHEET: 45 PUMP SERIES

STENNER PUMPS

SPECIFICATIONS

OUTPUT RANGE

adjustable models only, 5%-100%,
2.5% increments

MAXIMUM WORKING PRESSURE

100psi (1.7 bar) for the following models
45MHP2, 45MHP10, 45MHP22
45MHP2, 45MHP10, 45MHP22

25 psi (6.9 bar) for the following models

45M1, 45M2, 45M3, 45M4, 45M5
45MP1, 45MP2, 45MP3, 45MP4, 45MP5

MAXIMUM AMBIENT and FLUID TEMPERATURE

125°F (52° C)

MAXIMUM SUCTION LIFT

25' vertical lift

MOTOR TYPE

1/30 HP, shaded pole, class B

FINAL MOTOR RPM

26

DUTY CYCLE

Continuous

MOTOR VOLTAGE (AMP DRAW)

120V 60Hz 1PH (1.7)
220V 60Hz 1PH (0.9)
230V 50Hz 1PH (0.9) International
250V 50Hz 1PH (0.9) International

POWER CORD PLUG END

120V 60Hz - NEMA 5/15, 230V 50Hz - CEE 7/VII
220V 60Hz - NEMA 6/15, 250V 50Hz - CEE 7/VII

WET END COMPONENTS

PERISTALTIC TUBE

Santoprene® *FDA approved
optional Tygothane®*** FDA approved

TUBE FITTINGS, COMPRESSION NUTS

Type 1 rigid PVC-NSF listed

SUCTION STRAINER & WEIGHT

Type 1 rigid PVC body, ceramic weight - NSF listed

SUCTION/DISCHARGE TUBING & FERRULES

LDPE polyethylene, NSF and FDA approved

CHECK VALVE (injection fitting & body)

Type 1 rigid PVC-NSF listed

CHECK VALVE DUCKBILL

Santoprene®** FDA Approved
Pellathane®† (with Tygothane® tube)

OTHER COMPONENTS

ALL PUMP HOUSINGS

GE Lexan®†† Polycarbonate

PUMP HEAD ROLLERS

HDPE

ROLLER BUSHINGS

Bronze Oilite

ALL FASTENERS

Stainless Steel

POWER CORD TYPE

SJTOW

*Santoprene® is a registered trademark of Advanced Elastomer System.

**Tygothane® is a registered trademark of Saint-Gobain Performance Plastics.

†Pellathane® is a registered trademark of The Dow Company.

††Lexan® is a registered trademark of General Electric. Consult General Electric for chemical resistance of Lexan®

ACCESSORY KIT SHIPPED WITH EACH PUMP

- 3 connecting nuts 1/4" or 3/8"
- 3 ferrules 1/4" or 6mm *Europe*
OR 2 ferrules 3/8"
- 1 injection check valve 26-100 psi (1.7-6.9 bar)
OR 1 injection fitting 0-25 psi (0-1.7 bar)
- 1 weighted suction line strainer
1/4", 3/8" or 6mm *Europe*
- 1 20' roll suction/discharge tubing
1/4" or 3/8", white or UV black
OR 6 mm white *Europe*
- 1 spare pump tube
- 1 mounting bracket
- 1 manual

45 SERIES PUMP ADJUSTABLE OUTPUT

Single Head Model	Maximum Pressure	Pump Tube Number	Approximate Output @ 60 Hz						Approximate Output @ 50 Hz		
			gallons per day	liters per day	gallons per hour	liters per hour	ounces per minute	milliliters per minute	liters per day	liters per hour	milliliters per minute
45MHP2* 45M1	100 psi (6.9 bar) 25 psi (1.7 bar)	#1 #1	0.2 to 3.0	0.8 to 11.4	0.01 to 0.13	0.03 to 0.48	0.02 to 0.27	0.56 to 7.92	0.6 to 9.1	0.03 to 0.38	0.31 to 6.32
45MHP10* 45M2	100 psi (6.9 bar) 25 psi (1.7 bar)	#2 #2	0.5 to 10.0	1.9 to 37.9	0.02 to 0.42	0.08 to 1.58	0.04 to 0.89	1.32 to 26.32	1.5 to 30.3	0.06 to 1.26	1.04 to 21.04
45MHP22* 45M3	100 psi (6.9 bar) 25 psi (1.7 bar)	#7 #3	1.1 to 22.0	4.2 to 83.3	0.05 to 0.92	0.18 to 3.47	0.10 to 1.96	2.92 to 57.85	3.3 to 66.6	0.14 to 2.78	2.29 to 46.25
45M4	25 psi (1.7 bar)	#4	1.7 to 35.0	6.4 to 132.5	0.07 to 1.46	0.27 to 5.52	0.15 to 3.11	4.44 to 92.01	5.1 to 106.0	0.21 to 4.42	3.54 to 73.61
45M5	25 psi (1.7 bar)	#5	2.5 to 50.0	9.5 to 189.3	0.10 to 2.08	0.40 to 7.89	0.22 to 4.44	6.60 to 131.46	7.6 to 151.4	0.32 to 6.31	5.28 to 105.14

*Pump supplied with injection check valve for 26-100 psi (1.7-6.9 bar) applications

45 SERIES PUMP FIXED OUTPUT

Single Head Model	Maximum Pressure	Pump Tube Number	Approximate Output @ 60 Hz						Approximate Output @ 50 Hz		
			gallons per day	liters per day	gallons per hour	liters per hour	ounces per minute	milliliters per minute	liters per day	liters per hour	milliliters per minute
45MHP2* 45MP1	100 psi (6.9 bar) 25 psi (1.7 bar)	#1 #1	3.0	11.4	0.13	0.48	0.27	7.92	9.1	0.38	6.32
45MHP10* 45MP2	100 psi (6.9 bar) 25 psi (1.7 bar)	#2 #2	10.0	37.9	0.42	1.58	0.89	26.32	30.3	1.26	21.04
45MHP22* 45MP3	100 psi (6.9 bar) 25 psi (1.7 bar)	#7 #3	22.0	83.3	0.92	3.47	1.96	57.85	66.6	2.78	46.25
45MP4	25 psi (1.7 bar)	#4	35.0	132.5	1.46	5.52	3.11	92.01	106.0	4.42	73.61
45MP5	25 psi (1.7 bar)	#5	50.0	189.3	2.08	7.89	4.44	131.43	151.4	6.31	105.14

*Pump supplied with injection check valve for 26-100 psi (1.7-6.9 bar) applications

NOTICE: The information within this chart is solely intended for use as a guide. The output data is an approximation based on pumping water under a controlled testing environment. Many variables can affect the output of the pump. Stenner Pump Company recommends that all metering pumps undergo field calibration by means of analytical testing to confirm their outputs.



TRITON® C SERIES COMMERCIAL SAND FILTERS



For commercial and high-end residential swimming pools and other water applications. Available in flow rates from 98 to 141 gallons per minute.

Triton C and C-3 Series filters are designed for high efficiency and easy maintenance in high capacity commercial pool applications. A superior internal design levels the sand bed and produces an even water flow for the most efficient filtration possible. Our multi-diffuser system and slotted layer design give the Triton C filter superior filtration capacity and flow for longer cycles between cleanings, which significantly reduces operating costs.

Three-inch bulkheads (C-3 models) cut friction loss in half, and flanged connections don't require special adapters. The Triton C Series filter is engineered with single-piece tanks for superior strength, and made from the toughest materials available to withstand harsh chemicals and weather.

Capable of increased flow rates to 20 gpm per square foot of filter media, these filters are ideal for commercial applications and tandem installations when several filters are required.

STANDARD FEATURES

- 2" and 3" plumbing connections for maximum flow.
- 2" drains for easy winterizing.
- C and C-3 Series filters available in 30" and 36".
- Can be combined for tandem installation.
- NSF Listed.

TRITON® C SERIES COMMERCIAL SAND FILTERS

TRITON HD FILTER

The Triton heavy duty (HD) filter is a thirty-inch fiberglass filter that offers a maximum operating pressure of 75 PSI. This filter is specifically designed for special high-pressure commercial applications that require up to 98 gpm, and is ideal for all heavy-duty commercial applications.

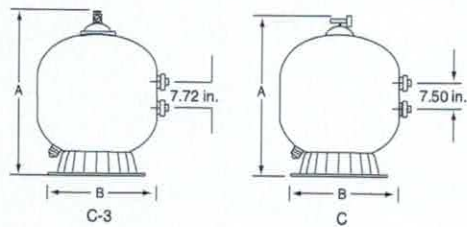

TR100 HD

Triton Commercial Series Sand Filter Specifications								
Model Number	Filter Area Sq. Ft.	Flow Rate	Turnover Capacity Gallons		Dimension		Media Required	
		15 GPM/sq. ft.*	6 Hours	8 Hours	A	B	Sand	Sand/Gravel
TR100C	4.91	74	26,640	35,520	39 1/4"	30 1/2"	600 lbs.	450 lbs./150 lbs.
TR140C	7.06	106	38,160	50,880	45 1/4"	36 1/2"	925 lbs.	650 lbs./275 lbs.
TR100C-3	4.91	74	26,640	35,520	39 1/4"	30 1/2"	600 lbs.	450 lbs./150 lbs.
TR140C-3	7.06	106	38,160	50,880	45 1/4"	36 1/2"	925 lbs.	650 lbs./275 lbs.

*15 GPM/sq. ft. typical commercial flow rate.

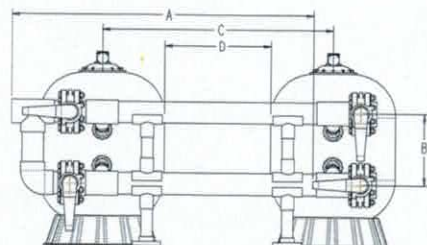

Two Filter System	A	B	C	D	Total Wt.
3" —TR100C	82 1/4"	17 3/8"	48" Min.	18" Min.	2,300 lbs.
3" —TR140C	88 1/4"	17 3/8"	54" Min.	18" Min.	3,200 lbs.
4" —TR140C	95 1/4"	19 3/8"	54" Min.	18" Min.	2,300 lbs.
6" —TR140C	111 1/4"	24 3/8"	54" Min.	18" Min.	3,550 lbs.

Note: 6" piping needs to be rotated upward as shown at 25° so handle will clear the floor.

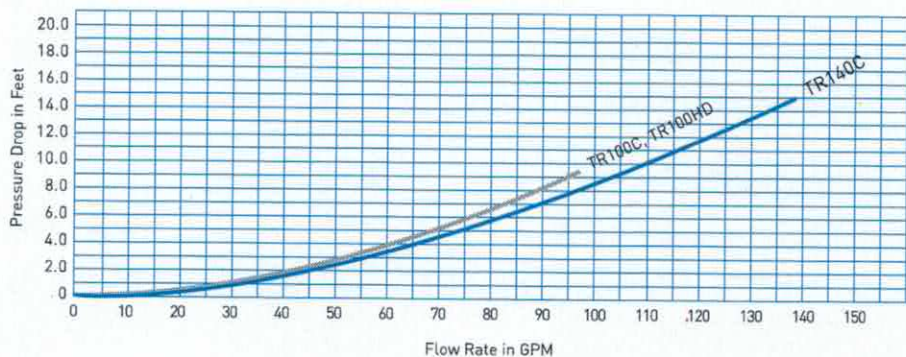

1620 HAWKINS AVE, SANFORD, NC 27330 800.831.7133 WWW.PENTAIRCOMMERCIAL.COM

All Pentair trademarks and logos are owned by Pentair, Inc. Triton® is a registered trademark of Pentair Water Pool and Spa, Inc. and/or its affiliated companies in the United States and/or other countries. Because we are continuously improving our products and services, Pentair reserves the right to change specifications without prior notice. Pentair is an equal opportunity employer.

11/13 Part # P1-151 ©2013 Pentair Water Pool and Spa, Inc. All rights reserved.



**EQ Series Commercial Pump
with Strainer Pot 6" x 4"**

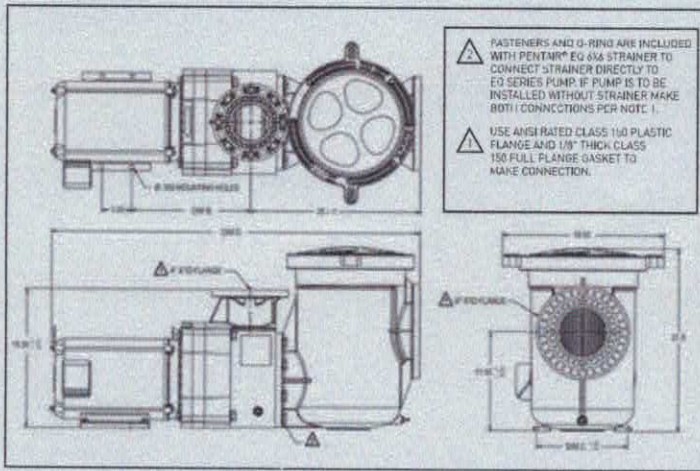

**EQ Series Commercial Pump
without Strainer Pot**

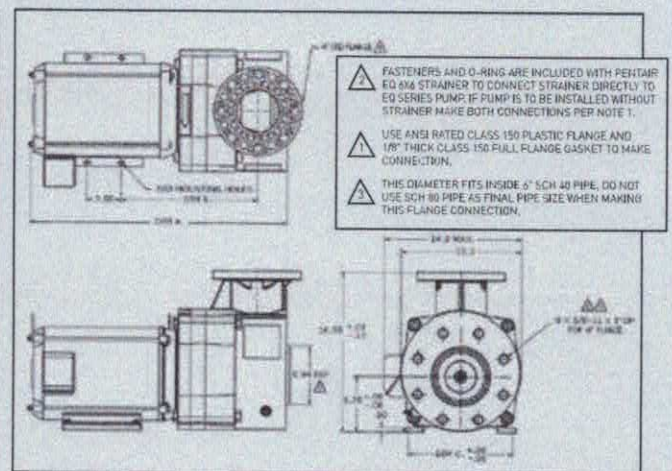

EQ Series Commercial Pump With Strainer Pot 6" x 4"

Part # ODP Motor	Part # TEFC Motor	Description	Voltage	Amps	Phase	HP	Wt	Dim. A-ODP	Dim. A-TEFC	Dim. B	Dim. C	Dim. D-ODP	Dim. D-TEFC
340026		EQW 300 WaterFall	208/230	38/19	1	3	126	26.62	N/A	10.03	7.5	43.590	N/A
340027		EQWK 300 WaterFall	208 - 230/460	8.4 - 7.9/3.9	3	3	106	23.12	N/A	10.16	7.5	40.094	N/A
340028		EQW 500 WaterFall	230	23.4	1	5	126	26.62	N/A	13.18	9.7	43.590	N/A
340029		EQWK 500 WaterFall	208 - 230/460	13.6 - 12.7/6.4	3	5	106	23.12	24.68	13.31	9.7	40.094	41.65
340030		EQ500	230	19.6	1	5	126	26.62	N/A	10.03	7.5	43.590	N/A
340031	340604	EQK500	208 - 230/460	13.5 - 12.3/6.2	3	5	106	23.12	24.68	10.16	7.5	40.094	41.65
340032		EQ750	230	30.4	1	7.5	161	27.53	N/A	10.78	8.5	44.590	N/A
340033	340605	EQK750	208 - 230/460	20.1 - 18.3/9.1	3	7.5	116	24.50	28.06	10.16	7.5	41.560	45.12
340034	340606	EQK1000	208 - 230/460	27.1 - 24.3/12.2	3	10	146	26.31	29.81	10.78	8.5	43.290	46.79
340035	340607	EQK1500	208 - 230/460	40.0 - 36.0/17.8	3	15	161	26.31	28.31	10.78	8.5	43.290	45.29
340238		EQ1000	230	40.0	1	10	179	29.0	N/A	11.50	8.5	46.29	N/A

340013	Strainer Pot Assembly including Strainer, Lid, Basket and Hardware
--------	--

EQ Series Commercial Pump Without Strainer Pot 6" x 6"

Part # ODP Motor	Part # TEFC Motor	Description	Voltage	Amps	Phase	HP	Wt
340014		EQW 300 WaterFall	115/230	38/19	1	3	97
340016		EQWK 300 WaterFall	208 - 230/460	8.4 - 7.9/3.9	3	3	77
340017		EQW 500 WaterFall	230	23.4	1	5	97
340018		EQWK 500 WaterFall	208 - 230/460	13.6 - 12.7/6.4	3	5	77
340019		EQ500	230	19.6	1	5	97
340020	340608	EQK500	208 - 230/460	13.5 - 12.3/6.2	3	5	77
340021		EQ750	230	30.4	1	7.5	132
340022	340609	EQK750	208 - 230/460	20.1 - 18.3/9.1	3	7.5	87
340237		EQ1000	230	40.0	1	10	125
340023	340610	EQK1000	208 - 230/460	27.1 - 24.3/12.2	3	10	117
340024	340611	EQK1500	208 - 230/460	40.0 - 36.0/17.8	3	15	132

EQ Series pumps are available in 575V and 50 Hz models. Please contact your local sales representative or Pentair office for details.

CERTIFICATION OF COMPLIANCE

Contains: WG1031BHF Description: 9"x9" Suction Outlet Cover

Ratings: Floor: 264 GPM Wall: 224 GPM Open Area: 23.18 sq-in

Certified to Comply with Section 1404 of the Virginia Graeme Baker Act (VGB) Pool & Spa Safety Act codified at 16 CFR part 1450. Initial Certification May 2011.

Manufactured: After September 10, 2009, by Division of Hayward Industries, Inc. at K4-A, 214028 Block K4- A, Export Processing Zone Wuxi New District Jiangsu Province PRC 214028, China.

Certified by Hayward Pool Products, 620 Division Street, Elizabeth, NJ 07207, Phone 908-355-7995
Contact at www.haywardnet.com

Record Custodian is Customer Service at www.haywardnet.com, Hayward Pool Products P.O. Box 5100 Clemmons, NC 27012-5100, Phone: 336-712-9900
<http://www.hayward-pool.com/pdf/literature/gx9highcoc.pdf>

Date of Mfr: The Lot Number shown on the product label contains the Year & Month of manufacture. The first number represents the year (ex 1 = 2011) and the second character the month (A=Jan, B=Feb, H=Aug, I is skipped, J=Sep, etc)

Tested to ANSI/ASME 112.19.8-2007 (addendum 9b-2009) per Section 1404 of the Virginia Graeme Baker Act (VGB) Pool & Spa Safety Act. Tested by IAPMO, 5001 E. Philadelphia Street, Ontario, CA 91761 (909)-472-4100 in April 2011. Certificate at: http://pld.iapmo.org/file_info.asp?file_no=0006353

Date of Installation: _____

Suction outlet components have a finite life, the cover/grate should be inspected frequently and replaced at least every 7 years or if found to be damaged, broken, cracked, missing, or not securely attached.

Hayward Pool Products acknowledges that it is a federal crime to knowingly and willingly make materially false, fictitious, or fraudulent statements, representations, or omissions on this certification.

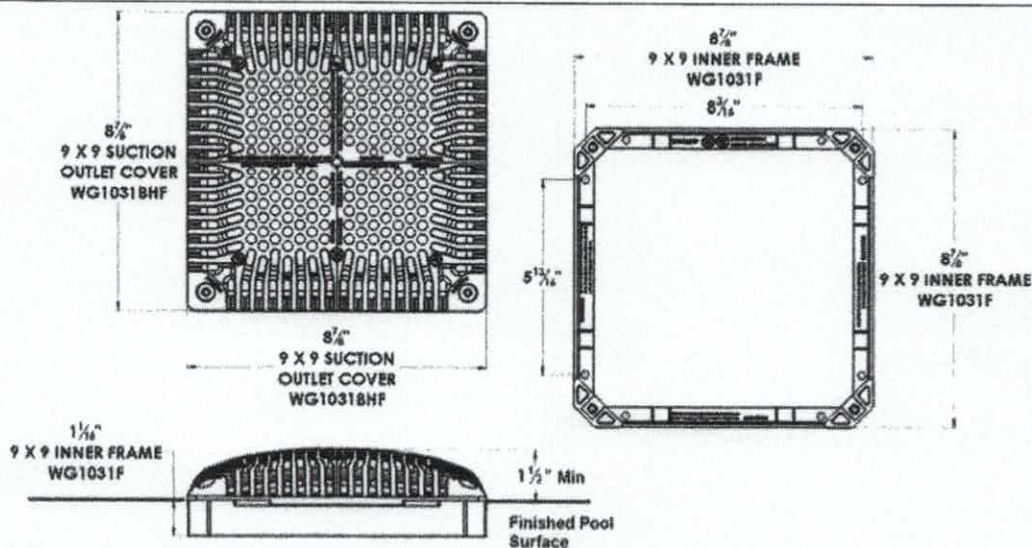

USE TO RETROFIT THE SP1033,
SP1033PAK2, AND SP1031

⚠ Warning – Suction Entrapment Hazard.

Suction in suction outlets and/or suction outlet covers which are installed in a small area and/or below the surrounding surface can cause severe injury or death due to body entrapment hazard.

To reduce the risk of body entrapment, installation of the field fabricated sumps must be such that the top of the mounted cover is a minimum of 1 1/2" above the finished pool surface over an area larger than 40" on a diagonal.



In-Ground Skimmers

FOR CONCRETE POOLS

Hayward in-ground pool skimmers are the preferred choice of professional pool builders. Engineered for residential and commercial applications, these large capacity skimmers are manufactured to Hayward's rigorous quality standards. Their durable, unibody construction is molded of rugged ABS, and they've been designed without submerged joints. Hayward skimmers come with multiple plumbing connections for easier installations.

All Hayward skimmers are non-corrosive, non-conductive and virtually indestructible, no matter what Mother Nature dishes out.

Skim-Master™ Series



Skim Master is a non-corrosive, large capacity automatic surface skimmer featuring a round, tamper-proof access cover, self-adjusting 8" weir with stainless steel spring for added strength, dual outlets, and threaded internal connections for pressure testing. The optional float/bypass valve provides a main drain-thru-skimmer system and an automatic safety bypass for low water conditions. No glue is used in manufacturing, promoting maximum strength and longevity. SP1070 Series provide a knockout overflow port that guards against overflow or pool water refill. All Skim-Master Series Skimmers are available with Float Valve and Equalizer Kit to meet specific NSF commercial requirements.



SP10712



Overflow Port

Model Number	Pipe Size	Cover Style	Throat Length	Ctn. Qty.	Ctn. Weight	Product Descriptions
SP1070	1 1/2" FIP	Round	4 1/2"	1	8 lbs.	ABS Body adjustable cover (deck) collar. Round tamper-proof cover, basket, weir, overflow port, Flo-Control plate. Dual outlets, have threaded internal cZons for pressure testing.
SP1070S	1 1/2" SKT	Round	4 1/2"	1	8 lbs.	
SP10712	2" FIP	Round	4 1/2"	1	8 lbs.	Same as SP1070 plus weir incorporated with Stainless Steel Spring.
SP10712S**	2" SKT	Round	4 1/2"	1	8 lbs.	

*Available In Gray, Dark Gray and Black. Add suffix GR for Gray, DGR for Dark Gray and BLK for Black.
 **Available with tan collar and cover. Add suffix 10 to model number.
 For skimmer packaged with float valve, add suffix FVA to model number.

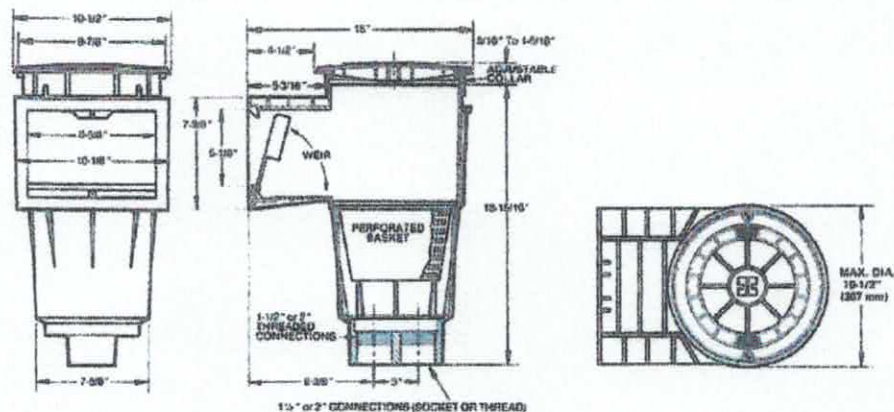

Measurements are for reference only.